



Permitted Openings In Wall & Ceiling Assemblies

The Building Standards Department issues Builder Tips as part of our customer service program. They are designed to provide an improved understanding of the Building Code and to reduce the costs associated with correcting infractions. Please contact your area building inspector for further information or call the Building Standards Department at 905.475.4848 extension 2189

9.10.5.1. Permitted Openings in Wall Membranes

(1) Except as permitted in Sentences (2) and (3), a membrane forming part of an assembly required to have a fire-resistance rating shall not be pierced by openings into the assembly unless the assembly has been tested and rated for such openings.

(2) A wall or ceiling membrane forming part of an assembly required to have a fire-resistance rating is permitted to be pierced by openings for electrical and similar service outlet boxes provided such outlet boxes and the penetrations conform to Article 9.10.9.8.

(2.1) Where boxes referred to in Sentence (2) are located on both sides of walls required to provide a fire-resistance rating, they shall be offset where necessary to maintain the integrity of the fire separation.

(3) A membrane ceiling forming part of an assembly assigned a fire-resistance rating on the basis of Table 2 of MMAH Supplementary Standard SB-3, “ Fire and Sound Resistance Tables”, is permitted to be pierced by openings leading to ducts within the ceiling space provided the ducts, the amount of openings and their protection conform to Sentence 9.10.13.14.(1) and the requirements in MMAH Supplementary Standard SB-2, “Fire Performance Ratings”.

OBJECTIVE

The Ontario Building Code permits openings in a wall membrane forming part of a fire rated wall assembly as long as these openings such as electrical outlet boxes are in conformance with Article 9.10.9.8. for the membrane providing the fire rating. When the outlet boxes are located in the same stud space they shall be separated by a material such as gypsum board to maintain the integrity of the fire separation of the wall assembly. Refer to the illustration for details.

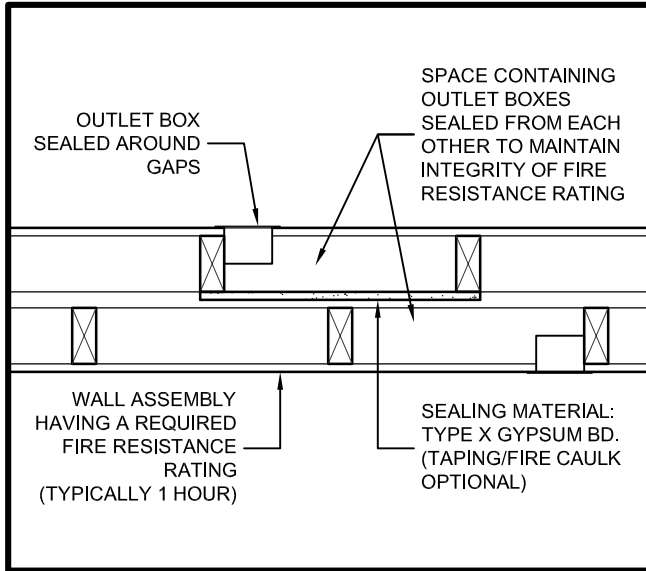

DOUBLE STUD WALL

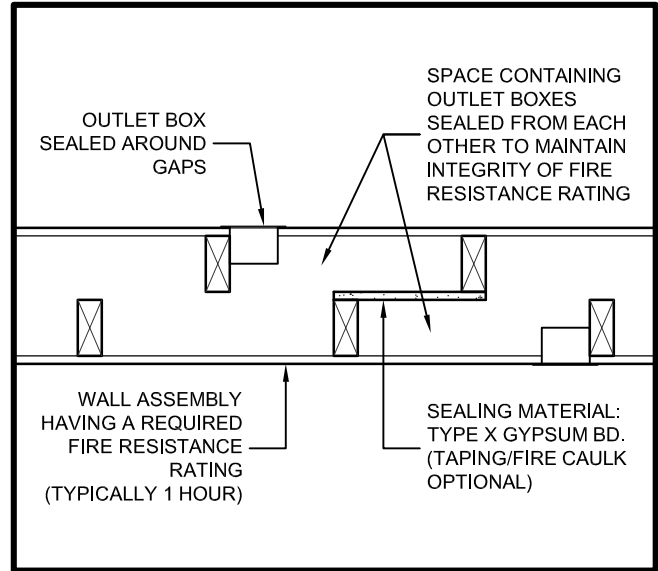

STAGGERED STUD WALL